

2003 INFORMATION SHEET

OPA #173

ISLANDER 9402

ISLANDER



TWO THOUSAND 3

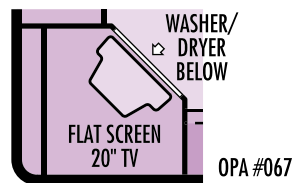
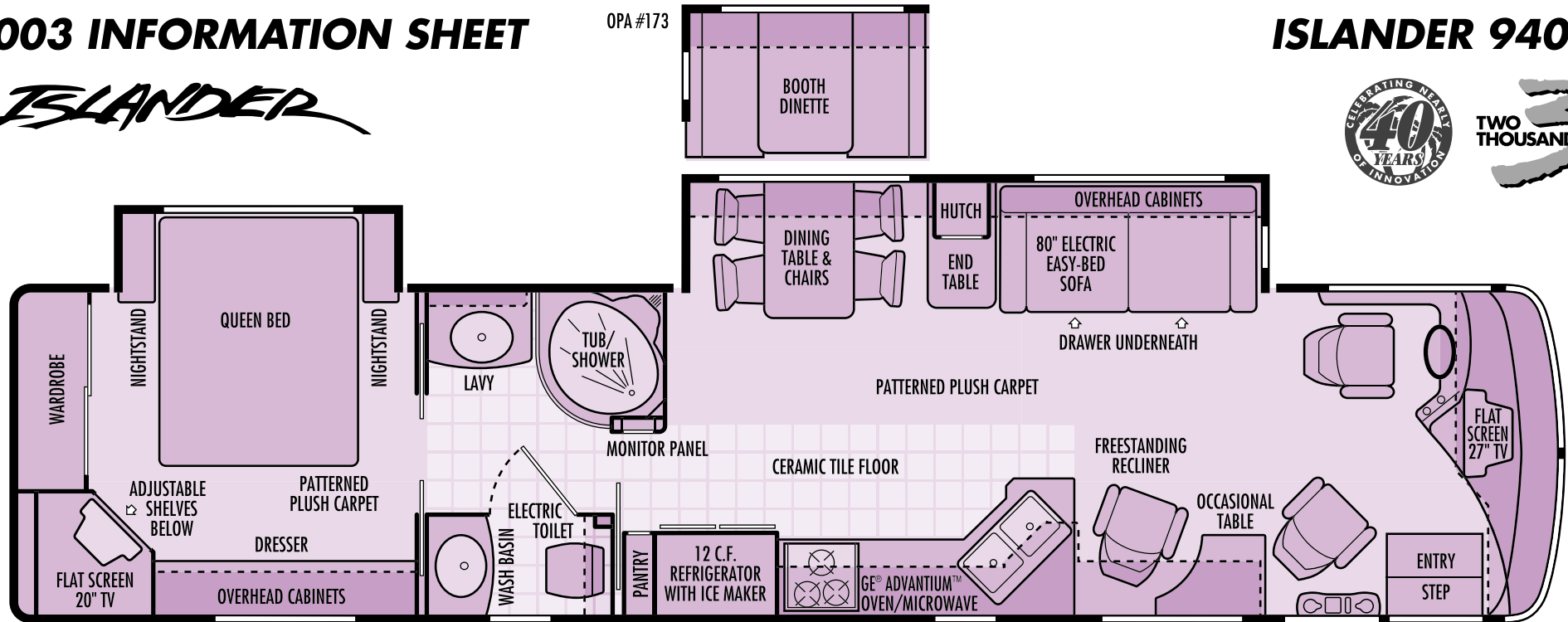

CHASSIS

Make/Model Dynamax 10TDX
 Design Tube Frame/Duraframe
 Axle Ratio 4.63:1
 Tires 12R x 22.5 (H)
 Service Brakes Full Air/Drums with ABS
 Shocks Koni Hydraulic Adjustable
 Alternator 160 Amp Leece-Neville
 Suspension Air Ride/Neway IFS
 Warranty 2 Years/Unlimited Miles

ENGINE

Make/Model Cummins ISL
 Displacement 8.9 Liters
 Peak HP 400 HP @ 2,000 RPM
 Peak Torque 1,200 ft/lbs @ 1,300
 Engine Brake 2-stage Jake Brake
 Warranty 5 Years/100,000 Miles

TRANSMISSION

Make/Model Allison MH 3000
 Type 6-Speed Automatic w/OD
 Shifter Electronic keypad
 Warranty 3 Years/Unlimited Miles

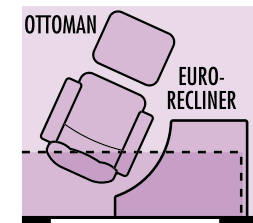

OPA #3116

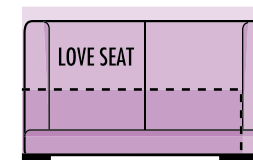

OPA #246

WEIGHT RATINGS (Pounds)

Gross Vehicle Weight Rating 34,400
 Gross Combined Weight Rating 44,400
 Front Gross Axle Weight Rating 14,400
 Rear Gross Axle Weight Rating 20,000
 Unloaded Vehicle Weight TBD
 Maximum Carrying Capacity TBD
 Cargo Carrying Capacity TBD

MEASUREMENTS

Wheelbase 275"
 Overall Length 39' 10"
 Overall Height TBD
 Interior Height 79 1/2"
 Interior Width 98 1/2"
 Exterior Width 102"

TANK CAPACITIES (Gallons)

Fuel (diesel) 150
 Fresh Water Tank 125
 Grey Tank 70
 Black Tank 70
 Water Heater 10
 LPG Tank (volume) 42.7



NOTE: Floorplans and features are subject to change without notice.
 © Copyright 03/2002 National R.V., Inc., 3411 N. Perris Boulevard, Perris, CA 92571 •

ISLA 9402