

Tradewinds

Fabrics



MARDI GRAS



TIFFANY



PACIFIC

Woods



OAK



WALNUT

Painted Graphics



SHOWN IN TABAGO BROWN

ALSO AVAILABLE:

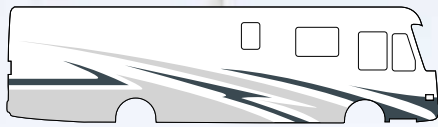

OAHU BLUE

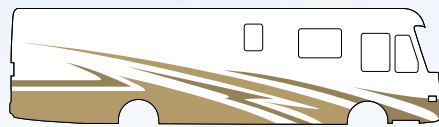

CAICOS GOLD

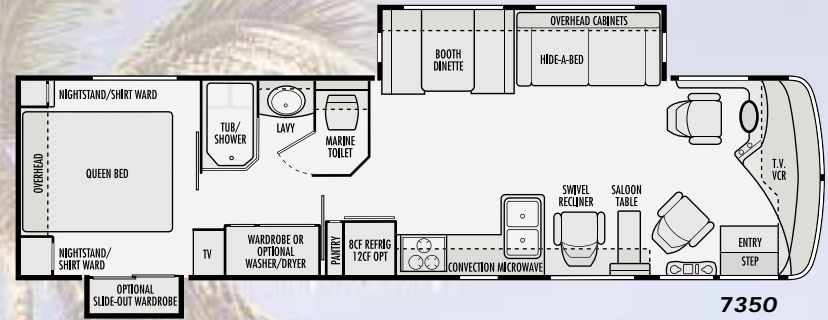

7350

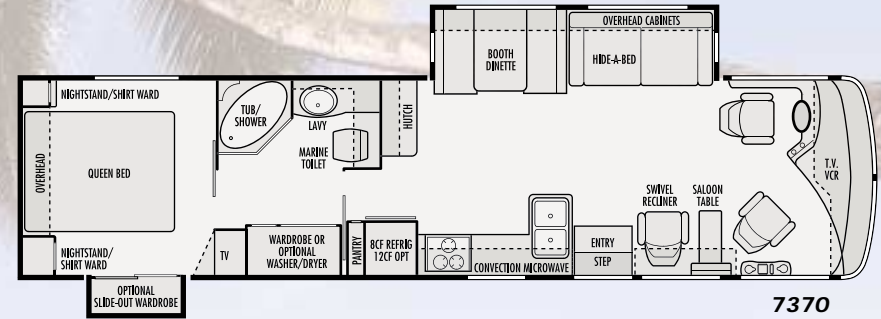

7370

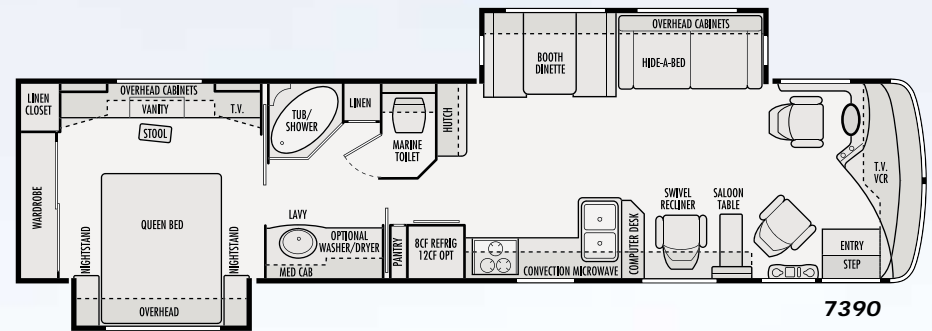

7390



TRADEWINDS FEATURES & SPECIFICATIONS

CHASSIS SPECIFICATIONS

Freightliner® XC Series Raised Rail Chassis
 TRW TAS 65 Integral hydraulic power steering gear, 12,000 lb. rating with 50° turning angle and 20.4:1 steering ratio
 Michelin® XRV radial tires 255/80R22.5 (G) on six 10 lug steel wheels with stainless steel wheel simulators
 Service Brakes: Full air brakes (drums) with ABS automatic heated air tank moisture ejectors, 15 x 4 front drums; 16.5 x 7 rear drums, S-cam style, automatic slack adjusters
 Parking Brakes: Spring applied, air release on rear drum brakes; push-pull lever control; automatic park brake
 Leece-Neville® 160 Amp alternator
 Two Alliance MF1031 1,500 CCA maintenance free chassis batteries
 Meritor® FD 965 I-beam wide track Front Axle 10,500 capacity with anti sway bar
 Neway® front air suspension and Neway® AD-200 17,500 lb capacity rear air suspension and manual electric air dump
 Tuned Bilstein® shock absorbers
 Dana Spicer® 1710 Series driveline
 Meritor® RS-17-145 driveline with 4.63:1 drive ratio
 90 gallon fuel tank dual fuel fill with remote mounted fuel/water separator
 Cooling Package: Rear mounted charge air cooler, radiator with belt driven cooling fan
 Remote mounted transmission oil cooler (water to oil)
 Filter Minder® air intake restriction indicator
 5,000 lb. Class III hitch receiver with skid bar and six pin electrical connector
 3 years/50,000 miles chassis warranty
 Caterpillar® 3126E, 300 HP @ 2,200 RPM and 860 lb. ft. torque @ 1,440 RPM with PacBrake exhaust brake, and 115V 1000 Watt block heater
 Allison® MH 3000, 6 speed electronic automatic transmission with digital display key pad shifter

BODY CONSTRUCTION

Duraframe® patented steel sub floor construction
 Steel framed laminated floor
 Steel framed crowned laminated roof
 Steel framed laminated fiberglass high gloss walls
 Front and rear molded fiberglass caps
 Integrated front and rear bumpers
 Insulated fiberglass exterior storage
 Compartment doors with integrated latches and gas struts

Electric slide-out room
 Aluminum rear ladder
 Automotive undercoating
 Custom vinyl exterior graphics

COCKPIT FEATURES

AM/FM stereo cassette and CD with four speakers
 Driver and passenger map lights
 Power steering
 Electronic cruise control
 Tilt and telescopic steering wheel
 12V/120V receptacle and telephone jack in console
 Rosen aviation style sun visors
 Snack tray cabinet with cup holders
 Dual dash fans (2 speed)
 Driver and extra wide passenger recliner seats with swivel bases
 Rear vision system with microphone
 Roof mounted dual trumpet air horns
 Power controlled heated exterior mirrors
 Pantographic windshield wipers
 4-point manual hydraulic leveling jacks
 Passenger work station

APPLIANCES & ACCESSORIES

8 cu. ft. double door refrigerator
 High output three-burner cook top
 Bi-fold range cover with Corian® top
 GE® Spacemaker® convection microwave with touch control and range hood
 TV antenna and booster with 12V receptacle and TV jack(s)
 Dust Buster® vacuum
 19" color TV with remote control in living area
 VCR with video switch box
 Coffee maker
 Wall mounted hair dryer in bath
 13" color TV with remote control in bedroom
 Systems monitor panel
 CB antenna and cable
 Home theater sound system

INTERIORS

Throughout Coach

Soft fabric ceiling material
 Praxis oak paneling and doors
 Solid wood square raised panel cabinet doors
 Deluxe cabinetry with hardwood overhead end panels and solid hardwood face framing
 Telestrut overhead storage doors and positive catches on all other doors
 Ball bearing rolling drawer guides

Living Area

Deluxe nylon carpet and pad

Pleated day/night shades
 Valances and lambrequins
 68" Hide-A-Bed® sofa
 Swivel rocker recliner
 Magazine rack
 Booth dinette with slide-out storage drawers
 Designer hutch shelf with Corian® and beveled "V" grooved mirrors
 Computer workstation with Corian® top (7390)

Kitchen Area

Corian® kitchen countertop with wood cutting block sink cover
 Corian® countertop extension
 Slideout pantry
 Waste basket
 Silverware organizer
 Mirrored galley back splash with "V" grooves
 Ceramic tile floor
 Venetian blind and valance (7370)

Bath Area

Ceramic tile floor
 Corian® bathroom lavy top
 Bathroom mirror with 1" bevel and frame
 Porcelain oval lavy sink
 Raised panel doors
 Insulated skylight in shower
 Towel bars
 Medicine cabinet

Bedroom Area

Deluxe nylon carpet and pad
 Pleated day/night shades
 Valances and lambrequins with Corian® tops
 Raised panel doors
 Queen bed slide-out (7390)
 Queen bed with wardrobe slide (7350 and 7370)
 Rear wardrobe with mirrored sliding doors (7390)
 Color coordinated bedspread, pillows and shams
 Radius padded headboard
 Nightstands with Corian® tops
 Cedar lining in wardrobe

ELECTRICAL SYSTEMS & LIGHTS

50 Amp 120V distribution panel and cord
 50 Amp shore power cord
 Dual 21 watt solar panel
 Generac® 6.6 kW LPG generator
 2,000 watt inverter/converter with remote on/off switch
 Four 6V deep cycle house batteries
 Two 760 CCA 12V maintenance-free chassis batteries
 Battery disconnect switch
 Three water pump switches (kitchen, bath and service station)

Auxiliary driving lights
 Porch light
 Patio receptacle
 Entry step light
 Fog lights
 Storage compartment lights
 Decorative overhead dining light
 Cosmetic light in bathroom (3-light with curved lens)
 Decorative lights in living area
 Fluorescent lights in ceiling
 Decorative scones in bedroom
 Decorative mood lights

PLUMBING & LPG SYSTEMS

Exterior of Coach

Heated and insulated holding and water tanks
 Manual dump valves
 Demand water system and Shur-Flo® water pump
 Water heater by-pass valve
 Winterization antifreeze inlet to pump
 Holding tank rinsing system (black tank only)
 Outside shower

Kitchen Area

Water filter in kitchen
 Six gallon gas/electric water heater
 Decorative faucets

Bath Area

Porcelain toilet with sprayer
 Clear glass shower enclosure with etched decorative design for privacy
 Decorative faucets
 Pre-plumbed for washer/dryer

SAFETY FEATURES

Fire extinguisher
 Deadbolt lock on entrance door
 12V GFI protected circuits (kitchen, bath and exterior)
 Smoke, carbon monoxide (CO) and LPG detectors
 Driver and passenger three point lap and shoulder seatbelts
 Egress windows
 Deluxe acrylic exterior assist handle
 3rd brake safety light
 Extra large rear view mirror with double convex

WINDOWS, DOORS & AWNINGS

Radius dual pane windows with tinted safety glass
 Sliding windows in living area, kitchen and driving area
 Power double entrance step with light and anti-skid

Radius entrance door with clear glass, roller shade (7370)
 PTL entrance door with clear glass and roller shade (7350 and 7390)
 Tinted dual pane windows
 Power step well cover (7390)
 Screen door
 Tinted skylight in bathroom
 Patio awning with metal cover*
 Slide-out awnings*

HEATING, VENTS & AIR CONDITIONING

Dual 13,500 BTU Duo-Therm® low profile Penguin® air conditioners with in-ceiling ducting
 35,000 BTU and 20,000 BTU furnaces (7370 and 7390)
 35,000 BTU furnace (7350)
 Dash heating and A/C system with defroster
 12V Fan-Tastic® Vent with wall thermostat and rain sensor in living area
 12V fan in bath

OPTIONAL FEATURES

Coach Exterior

Four aluminum wheels
 Electric patio awning*
 Generac® QuietPact 7.5 kW diesel generator
 Onan® 7.5 kW diesel generator
 Slide-out window awning*
 Bedroom window awning(s)*
 Front entry door awning (7350 and 7390)*

Throughout Coach

Walnut paneling and doors
 Maple paneling and doors

Living Area

Digital satellite system
 Ten disc CD player
 Leather package: Leather six-way power driver seat, leather extra wide passenger seat, leather sofa and leather recliner
 Leather six-way power driver seat
 Leather extra wide passenger seat
 Leather sofa
 Leather recliner
 Dining table with two high-back wooden chairs and two folding chairs
 Two wooden dining chairs
 JVC® DVD player

Kitchen Area

8 cu. ft. refer with ice maker
 12 cu. ft. side-by-side double door refer with absorption icemaker
 U-line ice maker
 21" high output three burner range and oven

Bath Area

Combination washer/dryer
 Electric toilet

Bedroom Area

Bedroom AM/FM cassette stereo with clock radio

| WEIGHTS (POUNDS) | 7350 | 7370 | 7390 |
|--------------------------------|-------------|-------------|-------------|
| Gross Vehicle Weight Rating | 26,850 lbs. | 26,850 lbs. | 26,850 lbs. |
| Gross Combined Weight Rating | 31,850 lbs. | 31,850 lbs. | 31,850 lbs. |
| Front Gross Axle Weight Rating | 9,350 lbs. | 9,350 lbs. | 9,350 lbs. |
| Rear Gross Axle Weight Rating | 17,500 lbs. | 17,500 lbs. | 17,500 lbs. |
| Unloaded Vehicle Weight | 21,800 lbs. | TBD | 22,780 lbs. |
| Maximum Carrying Capacity | 5,050 lbs. | TBD | 4,070 lbs. |
| Cargo Carrying Capacity | 3,314 lbs. | TBD | 2,334 lbs. |
| MEASUREMENTS | 7350 | 7370 | 7390 |
| Overall Length | 34' 10" | 36' 8" | 38' 6" |
| Overall Height (Road Height) | 12' 1/2" | 12' 1/2" | 12' 1/2" |
| Interior Height | 79 1/2" | 79 1/2" | 79 1/2" |
| Interior Width | 98" | 98" | 98" |
| Exterior Width | 102" | 102" | 102" |
| Wheelbase | 208" | 228" | 252" |
| TANK CAPACITIES | 7350 | 7370 | 7390 |
| Water Heater | 6 gal. | 6 gal. | 6 gal. |
| Gray Tank | 40 gal. | 40 gal. | 40 gal. |
| Black Tank | 45 gal. | 45 gal. | 45 gal. |
| Fresh Water Tank(s) | 95 gal. | 95 gal. | 95 gal. |
| LPG Tank (Volume W.C.) | 69 gal. | 69 gal. | 69 gal. |

*Not available on CSA units

Due to continued product improvement, National R. V., Inc. reserves the right to change materials, colors, specifications and prices at any time without notification. Copyright © 2001 by National R. V., Inc. 12/01