

# ISLANDER

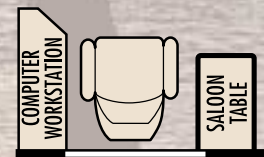
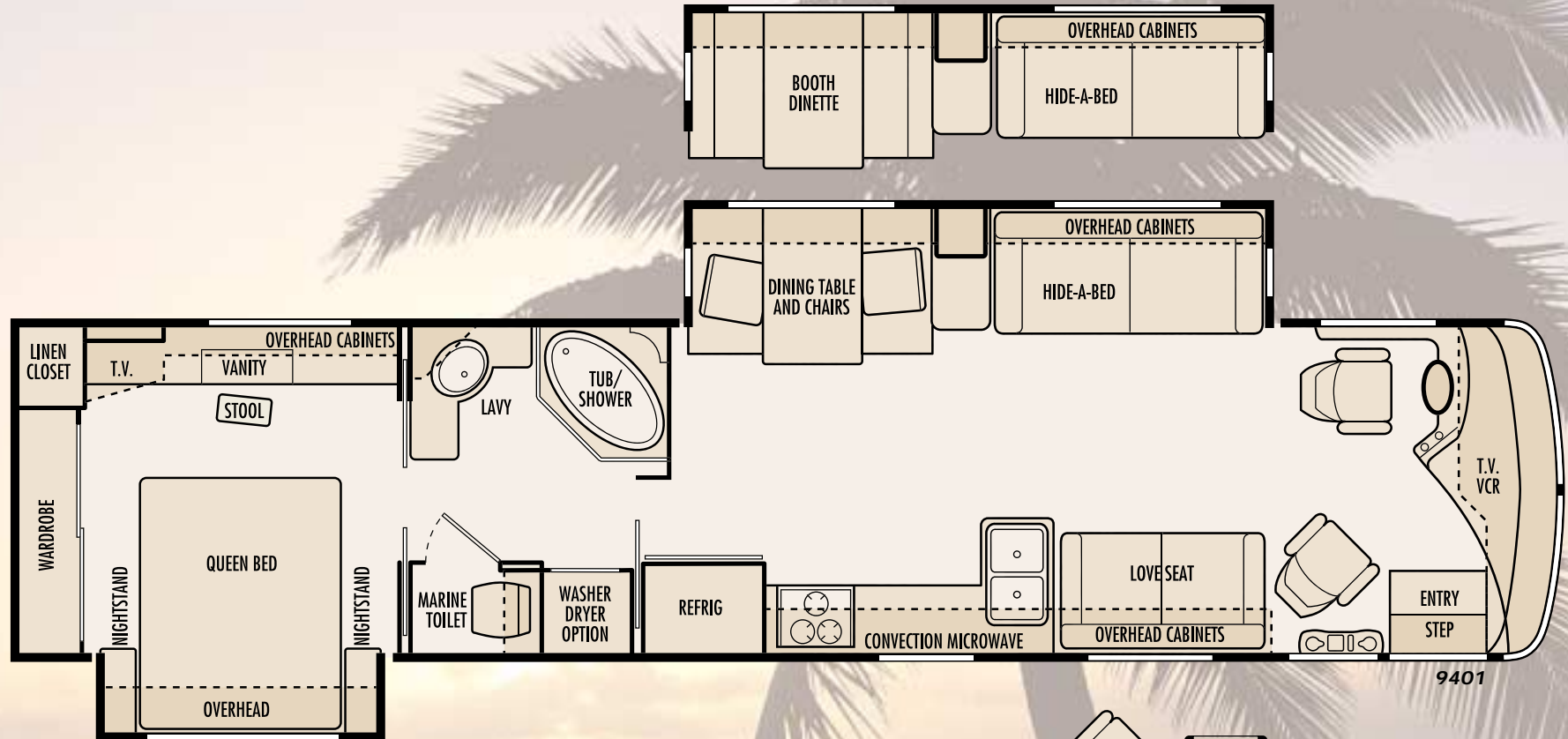

Due to continued product improvement, National R. V., Inc. reserves the right to change materials, colors, specifications and prices at any time without notification. Copyright © 2001 by National R. V., Inc. 08/01

3411 N. Perris Blvd. • Perris, CA 92571 909/943.6007

[www.nationalrv.com](http://www.nationalrv.com)

# ISLANDER FEATURES & SPECIFICATIONS

## CHASSIS, ENGINE & SUSPENSION

Dynamax® semi mono-coque chassis  
 Engine: Cummins® ISL, electronic diesel 8.9L displacement 370 HP @ 2,000 RPM  
 1,200 lb.-ft. torque @ 1,300 RPM  
 Allison® MH 3000 six speed world transmission  
 110 gallon fuel tank with dual fuel fills  
 Leece-Neville® 160 Amp alternator  
 Neway® independent front suspension  
 Rear axle ratio: 4.88:1  
 Front axle weight capacity: 13,200 lbs.  
 Rear axle weight capacity: 19,000 lbs.  
 Neway® full air suspension system  
 Dual air brakes  
 ABS braking system  
 JakeBrake® two stage engine brake  
 Two auxiliary air outlets  
 Four aluminum alloy wheels  
 Two inner dual steel wheels  
 Steel belted radial tires TOYO 275/70R 22.5(H)  
 Fleetguard® fuel/water separator  
 Dana® Spicer 1710 series driveline  
 Side mounted radiator with hydrostatic fan  
 Curbside access to service center, Filter Minder® and chassis battery disconnect  
 110V 1,000 watt engine block heater  
 7,000 lb. trailer hitch  
 Mud flaps  
 Chrome exhaust tip

## BODY CONSTRUCTION

Laminated steel framed floor  
 Laminated steel framed crowned fiberglass roof  
 Laminated steel framed smooth gelcoat fiberglass exterior walls (ultra high gloss)  
 Molded high gloss full fiberglass caps front and rear with integrated bumpers  
 Soft touch interior ceiling material  
 Electric slide-out rooms  
 Custom painted full body exterior graphics with choice of three color packages  
 Fiberglass exterior storage compartment doors, insulated with integrated paddle latches and struts  
 Automotive undercoating as required  
 Steel insulated front bulkhead

## COCKPIT FEATURES

AM/FM stereo CD with six speakers  
 Multi-disc CD changer

Leather power driver and power passenger recliner seats with swivel bases  
 Power passenger footrest  
 Driver and passenger map light with switch on dash  
 Custom dash with full gauge package  
 Convenience tray  
 Auxiliary driving lights  
 Pantographic windshield wipers  
 Power steering  
 Electronic cruise control  
 18" tilt and telescopic steering wheel  
 Roof mounted dual chrome trumpet air horns  
 Rear vision system with microphone  
 Chrome power controlled heated exterior mirrors  
 Remote controlled flood/spot lamp  
 Four high powered docking lights  
 Four-point manual hydraulic leveling jacks  
 Passenger workstation with 12V receptacle, phone jack and 110V receptacle  
 Aviation style sun visors  
 Cup holders  
 Two 2-speed dash fans  
 Electric stepwell cover  
 CB radio and antenna  
 Wraparound privacy curtain with easy reach wand  
 Illuminated stepwell

## APPLIANCES & ACCESSORIES

Home theater sound module  
 VCR with switch box  
 20" color TV with remote in living area and bedroom  
 12 cu. ft. side-by-side double door refrigerator and icemaker  
 Dust Buster® vacuum  
 High output three burner cook top  
 Bi-fold range cover with Corian® surface  
 GE® space saver convection microwave with turntable  
 Systems monitor panel  
 Digital satellite dish with TV antenna  
 Cable TV hook-up and telephone jacks  
 Bedroom AM/FM CD stereo with clock

## INTERIORS

**Throughout Coach**  
 Oak paneling and doors  
 Solid wood raised panel cabinet doors and face framing  
 Deluxe overhead storage doors with telestrut hardware; positive catches on all other doors  
 Ball bearing rolling drawer guides

## Living Area

Deluxe nylon carpet and pad in living area and bedroom  
 Pleated day/night shades in living area and bedroom  
 Valances and lambrequins in living area and bedroom  
 80" sofa  
 Recliner chair with swivel base  
 Dining table with two high-back wooden chairs and two folding chairs  
 Designer hutch shelf with Corian® and beveled V-grooved mirrors

## Kitchen Area

Corian® kitchen counter top with with color band and wood cutting block sink cover  
 Corian® countertop extension  
 Kitchen waste basket  
 Beveled mirror galley backsplash  
 Patterned ceramic tile floor in galley and bath  
 Venetian blind and valance in kitchen

## Bath Area

Corian® bathroom lavatory top  
 Porcelain oval lavatory sink  
 Raised panel doors in bath and bedroom area  
 Insulated skylight in shower  
 Towel bars in bathroom  
 Medicine cabinet

## Bedroom Area

Head-to-side queen bed slide-out  
 Bedspread, pillows and shams  
 Radius padded headboard  
 Nightstands with Corian® tops  
 Cedar lining in wardrobe  
 Rear wardrobe with mirrored sliding doors

## ELECTRICAL SYSTEMS & LIGHTS

50 Amp 120V distribution panel and cord  
 50 Amp shore power cord with power reel  
 Retractable TV cable reel  
 Dual 21 watt solar panel  
 Onan® QD 7.5 kW diesel generator  
 2,000 watt inverter/converter with remote on/off switch  
 Four 6V deep cycle house batteries  
 Two 760 CCA 12V maintenance free chassis batteries  
 Battery disconnect switch  
 Porch light  
 Patio receptacle  
 Entry step light  
 Three water pump switches (kitchen, bath and service station)

Decorative overhead dining light  
 Cosmetic light in bathroom  
 Decorative lights in living area  
 Fluorescent lights in ceiling  
 Decorative mood lights

## PLUMBING & LPG SYSTEMS

### Coach Exterior

Heated and insulated holding and water tanks  
 Electrical dump valves  
 Pressurized water fill  
 Demand water system and Shur-Flo® water pump  
 Water heater by-pass valve  
 Winterization antifreeze inlet to pump  
 Holding tank rinsing system (waste tank only)  
 Decorative kitchen and bath faucets  
 Outside shower  
 Electric hose reel

### Kitchen Area

Four stage full house water filtration system  
 Ten gallon gas/electric water heater  
 Decorative kitchen and bath faucets

### Bath Area

Porcelain toilet with sprayer  
 Clear glass shower enclosure with etched decorative design for privacy  
 One piece fiberglass tub and shower  
 Pre-plumbed for washer/dryer

## SAFETY FEATURES

Fire extinguisher  
 Deadbolt lock on entrance door  
 12V GFI protected circuit (kitchen, bath and exterior)  
 Smoke, carbon monoxide (CO) and LPG detectors  
 Driver and passenger three point lap and shoulder seatbelts  
 Egress windows  
 Deluxe acrylic exterior assist handle

## WINDOWS, DOORS & AWNINGS

Tinted dual pane windows  
 Power double entrance step with light and anti-skid  
 PTL entrance door with clear glass, roller shade  
 Screen door  
 Tinted skylight in bathroom  
 Slide-out topper awnings (living room/galley slide and bedroom slide)\*  
 Front entry door awning\*  
 Electric window awnings\*  
 Electric patio awning\*

## HEATING, VENTS & AIR CONDITIONING

Dual 13,500 BTU Duo-Therm® low profile Penguin® air conditioners with in-ceiling ducting  
 35,000 BTU and 20,000 BTU furnaces  
 Dash heating and A/C system with defroster  
 12V Fan-Tastic® Vent in bath  
 12V Fan-Tastic® Vent with wall thermostat and rain sensor in living area

## OPTIONAL FEATURES

### Throughout Coach

Walnut paneling and doors  
 Maple paneling and doors  
 Cherry paneling and doors

### Living Area

Booth dinette with slide-out storage drawers  
 Recliner with icemaker (replaces loveseat)  
 Recliner with computer workstation and saloon table (replaces loveseat)  
 Two wooden dining chairs  
 DVD player

### Kitchen Area

21" high output three burner range and oven

### Bath Area

Combination washer/dryer  
 High base electric toilet

## WEIGHTS (POUNDS) 9401

Gross Vehicle Weight Rating	32,200
Gross Combined Weight Rating	39,200
Front Gross Axle Weight Rating	13,200
Rear Gross Axle Weight Rating	19,000
Unloaded Vehicle Weight	26,100
Maximum Carrying Capacity	6,100

## MEASUREMENTS 9401

Wheelbase	275"
Overall Length	39'10"
Overall Height (Road Height)	11' 6"
Interior Height	79 1/2"
Exterior Width	102"

## TANK CAPACITIES 9401

Water Heater	10 gal.
Grey Tank	70 gal.
Black Tank	70 gal.
Fresh Water Tank	125 gal.
LPG Tank (Volume W.C.)	42.7 gal.

\*Not available on CSA units